

TRİGER KAYIŞ KASNAKLARI

8M

Hatve: 8 mm
Pitch:8 mm

TIMING BELT PULLEYS

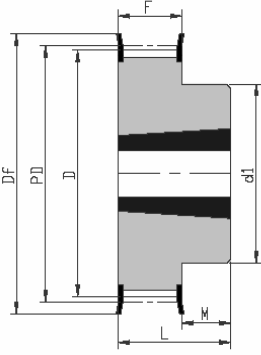

Tip F3

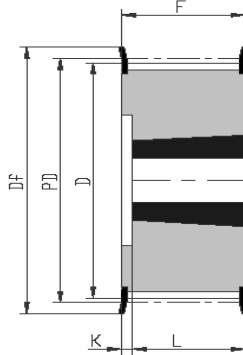

Tip F4

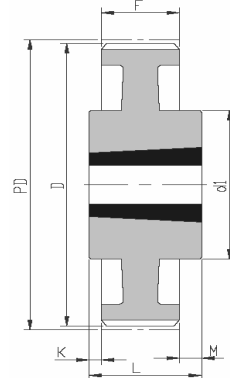

Tip T12

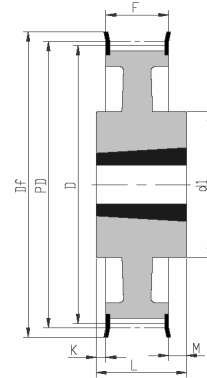

Tip F12

8M - Kayış genişliği Belt Width: 20 mm

Diş sayısı (z) Teeth Number(z)	Alt Grup Subgroup	Tip Type	Çap/Diameter			Burç No Taper Bush No	Delik/Bore (d)		Boyutlar/Dimensions (mm)					Ağırlık (kg) Weight(kg)	Kod Code	Malzeme Material
			P.D.	D	Df		Min	Max	d1	F	K	L	M			
22	8M	F4	56,02	54,65	65	1008	9	25	-	28	6	22	-	0,24	22 8M 20 F4-B	ÇELİK/STEEL
24	8M	F4	61,12	59,75	70	1108	9	28	-	28	6	22	-	0,3	24 8M 20 F4-B	
26	8M	F4	66,21	64,84	75	1108	9	28	-	28	6	22	-	0,36	26 8M 20 F4-B	
28	8M	F4	71,3	70,08	80	1108	9	28	-	28	6	22	-	0,44	28 8M 20 F4-B	
30	8M	F4	76,39	75,13	85	1210	11	28	-	28	3	25	-	0,45	30 8M 20 F4-B	
32	8M	F4	81,49	80,16	90	1210	11	42	-	28	3	25	-	0,5	32 8M 20 F4-B	
34	8M	F4	86,58	85,22	95	1610	14	42	-	28	3	25	-	0,55	34 8M 20 F4-B	
36	8M	F4	91,67	90,3	100	1610	14	42	-	28	3	25	-	0,68	36 8M 20 F4-B	
38	8M	F4	96,77	95,39	106	1610	14	42	-	28	3	25	-	0,8	38 8M 20 F4-B	
40	8M	F4	101,86	100,49	110	1610	14	42	-	28	3	25	-	1	40 8M 20 F4-B	
42	8M	F4	106,95	105,58	110	1610	14	42	-	28	3	25	-	1,11	42 8M 20 F4-B	
44	8M	F3	112,05	110,67	121	2012	14	50	92	28	-	32	4	1,2	44 8M 20 F3-B	
48	8M	F3	122,23	120,86	131	2012	14	50	96	28	-	32	4	1,6	48 8M 20 F3-B	
56	8M	F3	142,6	141,23	151	2012	14	50	110	28	-	32	4	2,4	56 8M 20 F3-B	
60	8M	F3	152,79	151,42	162	2012	14	50	110	28	-	32	4	2,55	60 8M 20 F3-B	
64	8M	F12	162,97	161,6	171	2012	14	50	110	28	-	32	4	2,7	64 8M 20 F12-B	
72	8M	F12	183,35	181,97	192	2012	14	50	110	28	-	32	4	3,3	72 8M 20 F12-B	
80	8M	T12	203,72	202,35	-	2517	16	50	125	28	-	45	17	3,5	80 8M 20 T12-B	
90	8M	T12	229,18	227,81	-	2517	16	50	125	28	-	45	17	3,65	90 8M 20 T12-B	

İstendiğinde farklı malzemeden aynı ürünler yapılabilir.

If requested, these items can be produced from different materials.

TRİGER KAYIŞ KASNAKLARI

TIMING BELT PULLEYS

Hatve: 8 mm
Pitch: 8 mm

8M

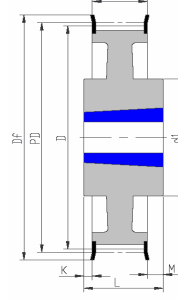
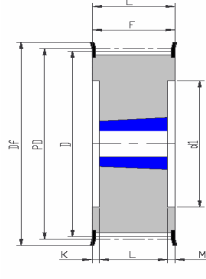
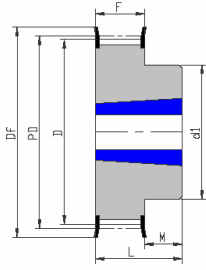
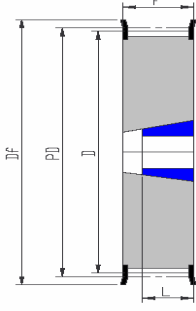

Tip F2

Tip F3

Tip F6

Tip T12

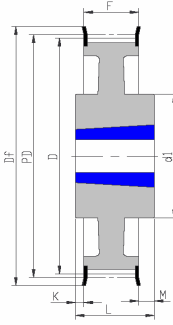
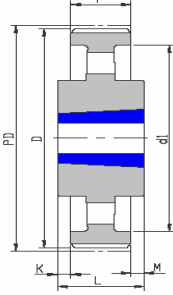
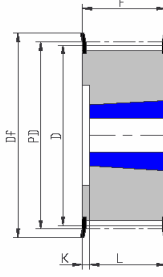

Tip F4

Tip T10

Tip F12

8M - Kayış genişliği Belt Width: 30 mm

Diş sayısı (z) Teeth Number(z)	Alt Grup Subgroup	Tip Type	Çap/Diameter			Burç No Taper bush no	Delik/Bore (d)		Boyutlar/Dimensions (mm)					Ağırlık (kg) Weight(kg)	Kod Code	Malzeme Material
			P.D.	D	Df		Min	Max	d1	F	K	L	M			
20	8M	F4	50,93	49,56	60	1008	9	25	38	16	22	-	0,23	20 8M 30 F4-B	ÇELİK/STEEL	
21	8M	F4	53,47	52,1	65	1008	9	25	38	16	22	-	0,26	21 8M 30 F4-B		
22	8M	F4	56,02	54,65	65	1008	9	25	38	16	22	-	0,29	22 8M 30 F4-B		
23	8M	F4	58,57	57,2	70	1108	9	28	38	16	22	-	0,32	23 8M 30 F4-B		
24	8M	F4	61,12	59,75	70	1108	9	28	38	16	22	-	0,38	24 8M 30 F4-B		
25	8M	F4	63,66	62,29	75	1108	9	28	38	16	22	-	0,41	25 8M 30 F4-B		
26	8M	F4	66,21	64,84	75	1108	9	28	38	16	22	-	0,45	26 8M 30 F4-B		
27	8M	F4	68,75	67,38	80	1108	9	28	38	16	22	-	0,49	27 8M 30 F4-B		
28	8M	F4	71,3	70,08	80	1108	9	28	38	16	22	-	0,5	28 8M 30 F4-B		
30	8M	F2	76,39	75,13	85	1210	11	42	38	-	25	-	0,55	30 8M 30 F2-B		
31	8M	F2	78,94	77,57	90	1610	14	42	38	-	25	-	0,57	31 8M 30 F2-B		
32	8M	F2	81,49	80,16	90	1610	14	42	38	-	25	-	0,59	32 8M 30 F2-B		
33	8M	F2	84,03	82,66	95	1610	14	42	38	-	25	-	0,73	33 8M 30 F2-B		
34	8M	F2	86,58	85,22	95	1610	14	42	38	-	25	-	0,77	34 8M 30 F2-B		
35	8M	F2	89,13	87,75	100	1610	14	42	38	-	25	-	0,82	35 8M 30 F2-B		
36	8M	F2	91,67	90,3	100	1610	14	42	38	-	25	-	0,96	36 8M 30 F2-B		
38	8M	F2	96,77	95,39	106	1610	14	42	38	-	25	-	1,15	38 8M 30 F2-B		
40	8M	F2	101,86	100,49	110	1610	14	42	38	-	25	-	1,34	40 8M 30 F2-B		
42	8M	F2	106,95	105,58	110	1615	14	42	38	-	28	-	1,36	42 8M 30 F2-B		
44	8M	F6	112,05	110,67	121	2012	14	50	38	6	32	-	1,33	44 8M 30 F6-B		
45	8M	F6	114,59	113,22	121	2012	14	50	38	6	32	-	1,62	45 8M 30 F6-B		
48	8M	F6	122,23	120,86	131	2012	14	50	38	6	32	-	1,78	48 8M 30 F6-B		
50	8M	F6	127,32	125,95	136	2012	14	50	38	3	32	3	2,08	50 8M 30 F6-B		
52	8M	F6	132,42	131,04	141	2012	14	50	38	3	32	3	2,39	52 8M 30 F6-B		
56	8M	F6	142,6	141,23	151	2012	14	50	38	6	32	-	3,76	56 8M 30 F6-B		
58	8M	F6	147,7	146,32	156	2012	14	50	38	3	32	3	3,87	58 8M 30 F6-B		
60	8M	F6	152,79	151,42	162	2517	16	60	38	3	45	3	3,98	60 8M 30 F6-B		
64	8M	F3	162,97	161,6	171	2517	16	60	38	-	45	7	4,2	64 8M 30 F3-B		
72	8M	F12	183,35	181,97	192	2517	16	60	38	-	45	7	4,3	72 8M 30 F12-B		
80	8M	T12	203,72	202,35	-	2517	16	60	38	-	45	7	4,6	80 8M 30 T12-B		
90	8M	T12	229,18	227,81	-	2517	16	60	38	-	45	7	5	90 8M 30 T12-B		
112	8M	T12	285,21	283,83	-	2517	16	60	38	-	45	7	6,2	112 8M 30 T12-B		
144	8M	T12	366,69	365,32	-	2517	16	60	38	-	45	7	9	144 8M 30 T12-B		
168	8M	T10	427,81	426,44	-	3020	25	75	38	7	51	7	15	168 8M 30 T10-B		
192	8M	T10	488,92	487,55	-	3525	35	100	38	14	65	7	18,5	192 8M 30 T10-B		

İstendiğinde farklı malzemeden aynı ürünler yapılabilir.
If requested, these items can be produced from different materials.

8M

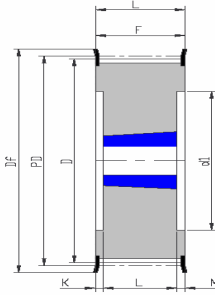
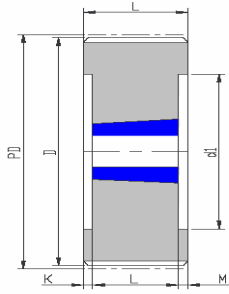
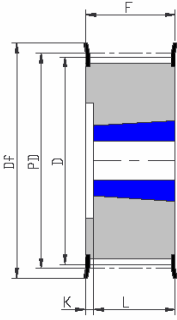
Hatve: 8 mm
Pitch:8 mm

Tip F4

Tip T6

Tip F6

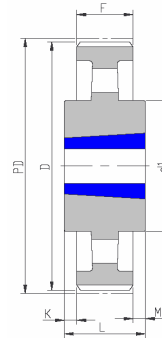
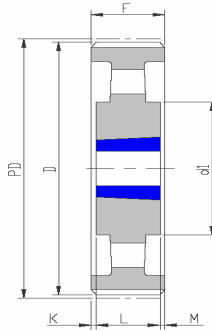
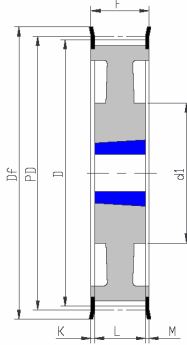
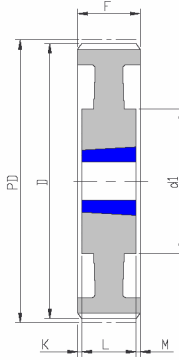

Tip T7

Tip F7

Tip T8

Tip T10

8M - Kayış genişliği Belt Width: 50 mm

Diş sayısı (z) Teeth Number(z)	Alt Grup Subgroup	Tip Type	Çap/Diameter			Burç No Taper bush no	Delik/Bore (d)		Boyutlar/Dimensions (mm)					Ağırlık (kg) Weight(kg)	Kod Code	Malzeme Material
			P.D.	D	Df		Min	Max	d1	F	K	L	M			
24	8M	F6	61,12	59,75	70	1108	9	32	-	60	19	22	19	0,35	24 8M 50 F6-B	ÇELİK/STEEL
26	8M	F6	66,21	64,84	75	1108	9	32	-	60	19	22	19	0,48	26 8M 50 F6-B	
27	8M	F6	68,75	67,38	75	1108	9	32	-	60	19	22	19	0,55	27 8M 50 F6-B	
28	8M	F4	71,3	70,08	80	1108	9	32	-	60	19	22	19	0,6	28 8M 50 F4-B	
30	8M	F4	76,39	75,13	85	1210	11	42	-	60	35	25	-	0,65	30 8M 50 F4-B	
31	8M	F4	78,94	77,57	87	1610	14	42	-	60	35	25	-	0,77	31 8M 50 F4-B	
32	8M	F4	81,49	80,16	90	1610	14	42	-	60	35	25	-	0,82	32 8M 50 F4-B	
33	8M	F4	84,03	82,66	90	1610	14	42	-	60	35	25	-	0,98	33 8M 50 F4-B	
34	8M	F4	86,58	85,22	95	1610	14	42	-	60	35	25	-	1,06	34 8M 50 F4-B	
35	8M	F4	89,13	87,75	95	1610	14	42	-	60	35	25	-	1,18	35 8M 50 F4-B	
36	8M	F4	91,67	90,3	100	1610	14	42	-	60	35	25	-	1,3	36 8M 50 F4-B	
38	8M	F4	96,77	95,39	105	1610	14	42	-	60	35	25	-	1,6	38 8M 50 F4-B	
40	8M	F6	101,86	100,49	110	2012	14	50	-	60	28	32	-	1,71	40 8M 50 F6-B	
42	8M	F6	106,95	105,58	111	2012	14	50	-	60	-	32	28	1,75	42 8M 50 F6-B	
44	8M	F6	112,05	110,67	121	2012	14	50	-	60	-	32	28	1,78	44 8M 50 F6-B	
45	8M	F6	114,59	113,22	121	2012	14	50	-	60	-	32	28	1,91	45 8M 50 F6-B	
48	8M	F6	122,23	120,86	131	2012	14	50	-	60	-	32	28	2,3	48 8M 50 F6-B	
50	8M	F6	127,32	125,95	131	2012	14	50	-	60	-	32	28	2,58	50 8M 50 F6-B	
52	8M	F6	132,42	131,04	140	2012	14	50	-	60	-	32	28	2,85	52 8M 50 F6-B	
56	8M	F6	142,6	141,23	151	2517	16	60	-	60	-	45	15	3,4	56 8M 50 F6-B	
58	8M	F6	147,7	146,32	156	2517	16	60	-	60	-	45	15	3,8	58 8M 50 F6-B	
60	8M	F6	152,79	151,42	158	2517	16	60	-	60	-	45	15	4,2	60 8M 50 F6-B	
64	8M	F6	162,97	161,6	171	2517	16	60	-	60	-	45	15	5	64 8M 50 F6-B	
72	8M	F7	183,35	181,97	192	2517	16	60	125	60	7,5	45	7,5	6,7	72 8M 50 F7-B	
80	8M	T6	203,72	202,35	-	2517	16	75	-	60	4,5	45	4,5	8,8	80 8M 50 T6-B	
90	8M	T7	229,18	227,81	-	3020	25	75	160	60	4,5	51	4,5	10	90 8M 50 T7-B	
112	8M	T7	285,21	283,83	-	3020	25	75	170	60	4,5	51	4,5	12	112 8M 50 T7-B	
144	8M	T8	366,69	365,32	-	3020	25	75	170	60	4,5	51	4,5	15,2	144 8M 50 T8-B	
168	8M	T10	427,81	426,44	-	3020	25	100	170	60	4,5	51	4,5	16,4	168 8M 50 T10-B	
192	8M	T10	488,92	487,55	-	3020	25	100	170	60	4,5	51	4,5	21,8	192 8M 50 T10-B	

İstendiğinde farklı malzemeden aynı ürünler yapılabilir.

If requested, these items can be produced from different materials.

8M

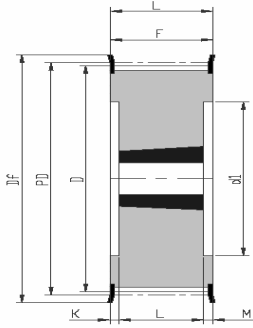
Hatve: 8 mm
Pitch:8 mm

Tip F6

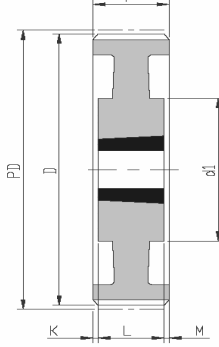

Tip T7

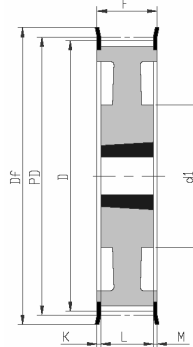

Tip F7

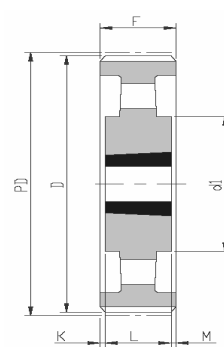

Tip T8

8M - Kayış genişliği Belt Width: 85 mm

Dış sayısı (z)	Alt Grup	Tip	Çap/Diameter			Burç No	Delik/Bore (d)		Boyutlar/Dimention (mm)					Ağırlık (kg)	Kod	Malzeme
Teeth Number(z)	Subgroup	Type	P.D.	D	Df	Taper bush no	Min	Max	d1	F	K	L	M	Weight(kg)	Code	Material
24	8M	F6	61,12	59,75	70	1108	9	32	-	95	36,5	22	36,5	0,46	24 8M 85 F6-B	ÇELİK/STEEL
26	8M	F6	66,21	64,84	75	1108	9	32	-	95	36,5	22	36,5	0,64	26 8M 85 F6-B	
28	8M	F6	71,3	70,08	80	1108	9	32	-	95	36,5	22	36,5	0,82	28 8M 85 F6-B	
30	8M	F6	76,39	75,13	85	1615	14	32	-	95	36,5	22	36,5	1,17	30 8M 85 F6-B	
33	8M	F6	84,03	82,66	90	1615	14	42	-	95	36,5	22	36,5	1,34	33 8M 85 F6-B	
34	8M	F6	86,58	85,22	95	1615	14	42	-	95	28,5	38	28,5	1,43	34 8M 85 F6-B	
35	8M	F6	89,13	87,75	95	1615	14	42	-	95	28,5	38	28,5	1,54	35 8M 85 F6-B	
36	8M	F6	91,67	90,3	100	1615	14	42	-	95	28,5	38	28,5	1,87	36 8M 85 F6-B	
38	8M	F6	96,77	95,39	105	1615	14	42	-	95	28,5	38	28,5	2,2	38 8M 85 F6-B	
40	8M	F6	101,86	100,49	110	2012	14	42	-	95	31,5	32	31,5	1,8	40 8M 85 F6-B	
42	8M	F6	106,95	105,58	111	2012	14	42	-	95	31,5	32	31,5	2,16	42 8M 85 F6-B	
44	8M	F6	112,05	110,67	121	2012	14	42	-	95	31,5	32	31,5	2,3	44 8M 85 F6-B	
45	8M	F6	114,59	113,22	121	2012	14	50	-	95	31,5	32	31,5	2,39	45 8M 85 F6-B	
48	8M	F6	122,23	120,86	131	2517	16	50	-	95	25	45	25	2,66	48 8M 85 F6-B	
50	8M	F6	127,32	125,95	131	2517	16	50	-	95	25	45	25	3,11	50 8M 85 F6-B	
52	8M	F6	132,42	131,04	140	2517	16	50	-	95	25	45	25	3,56	52 8M 85 F6-B	
56	8M	F6	142,6	141,23	151	2517	16	50	-	95	25	45	25	4,45	56 8M 85 F6-B	
58	8M	F6	147,7	146,32	156	2517	16	50	-	95	25	45	25	4,89	58 8M 85 F6-B	
60	8M	F6	152,79	151,42	158	2517	16	50	-	95	25	45	25	5,33	60 8M 85 F6-B	
64	8M	F7	162,97	161,6	171	2517	16	60	-	95	25	45	25	6,2	64 8M 85 F7-B	
72	8M	T7	183,35	181,97	192	3020	25	60	-	95	22	51	22	8	72 8M 85 T7-B	
80	8M	T8	203,72	202,35	-	3020	25	60	-	95	22	51	22	10	80 8M 85 T8-B	
90	8M	T8	229,18	227,81	-	3020	25	60	-	95	22	51	22	10,8	90 8M 85 T8-B	
112	8M	T8	285,21	283,83	-	3020	25	60	170	95	22	51	22	15	112 8M 85 T8-B	
144	8M	T8	366,69	365,32	-	3535	35	75	190	95	3	89	3	20	144 8M 85 T8-B	
168	8M	T8	427,81	426,44	-	3535	35	75	190	95	3	89	3	23	168 8M 85 T8-B	
192	8M	T8	488,92	487,55	-	3535	35	75	190	95	3	89	3	28,5	192 8M 85 T8-B	

İstendiğinde farklı malzemeden aynı ürünler yapılabilir.

If requested, these items can be produced from different materials.